

## Compass™ Specifications

Characteristic	Value
Pressure Range	-500 to +500 mm Hg
Accuracy	± 2 mm Hg: < 50mm Hg ± 3 mm Hg: 50–100mm Hg ± 5 mm Hg: 100–300mm Hg ± 10 mm Hg: >300mm Hg
Zero Drift	± 1 mm Hg per 4 hours
Operating Life	8 hours
Operating Temperature	15 to 40°C (32 to 104°F)
Storage Temperature	-29 to 49°C (-20 to 120°F)
Light Sensitivity	< 1 mm Hg
Lithium Battery Voltage	3 Volts

## Software Error Codes

### Display Meaning

SF	Software Failure
HF	Hardware Failure
PF	Pressure Sensor Failure
bF	Battery Failure
EE	Environmental Error– outside operating temperature
CE	Calibration Error– outside required accuracy



### Mirador Biomedical, Inc.

2815 Eastlake Ave E. Suite 220  
Seattle, WA 98102 USA  
(206) 407-3595

PN-00100-001 CCMP001



Emergo Europe  
Molenstraat 15  
2513 BH The Hague  
The Netherlands  
Tel: (31) (0) 70 345-8570  
Fax: (31) (0) 70 346-7299



## Compass™ Compartment Pressure

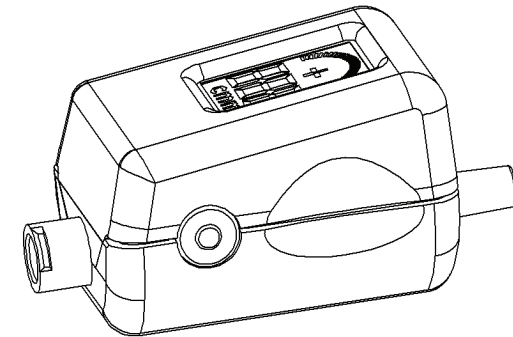

**Indications for Use: The Compass™ disposable pressure transducer with integrated digital display is intended for measurement of physiological pressure**

Information for Use: Please review prior to use

Caution: Federal (USA) law restricts this device to sale by or on the order of a physician.

Device is sterile if pouch is unopened and undamaged.

This product is designed for single use only.

Do not resterilize or reuse.

CE 0459

## DESCRIPTION

The COMPASS is a self-calibrating, single use, sterile device for measuring physiological pressure.

## SUGGESTED USE

1. Remove COMPASS from its sterile packaging.  
Remove proximal luer cap if attaching accessories (e.g. stopcock or syringe) to proximal end of COMPASS.

2. Activate and calibrate COMPASS by depressing power button until display reads "000".

**WARNING: Turn on COMPASS prior to connecting accessories to avoid incorrect baseline reading.**

3. Connect COMPASS to accessory monitoring equipment (e.g. needle, catheter, stopcocks, syringe, flush devices, tubing administration sets, etc.) per hospital protocol.

**NOTE: Attach distal (male luer) side of COMPASS to needle or catheter in contact with patient.**

**WARNING: Do not reinfuse blood or other fluid into patient after any such fluid is drawn into the COMPASS.**

**WARNING: Pressure reading is NOT physiological if either the front or the rear of the device is open to atmospheric pressure.**

4. Pressure is displayed on COMPASS LCD

**NOTE: If COMPASS pressure reading does not return to zero after removal from needle or catheter, flush device with saline and then cycle device (turn it off and then back on) to recalibrate.**

**WARNING: Do not reuse COMPASS for more than one procedure in the same patient. Use a new COMPASS device for each procedure.**

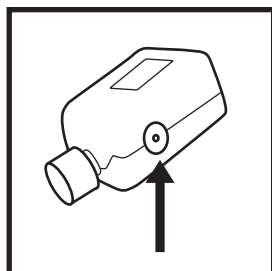

Fig. 1

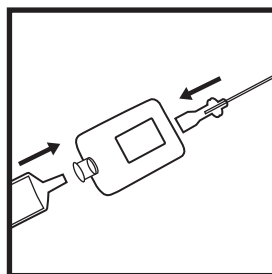

Fig. 2

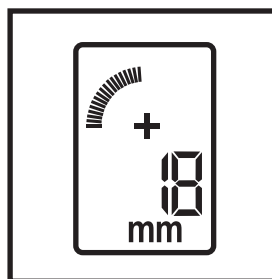

Fig. 3

## DEVICE POWER OFF AND MODE SELECT

Press button three times in a "PUSH", "PUSH", "HOLD" sequence; quickly push button twice and then hold third button push until device turns off.

## DISPLAY

